



INSTALL AND TUNING INSTRUCTIONS

CAN AM X3 KWIK LOCK BELT CHANGE TOOL

PART NUMBER(s): KWIKLOCKX3

**WE ARE NOT RESPONSIBLE FOR ANY DAMAGES.
BE VERY CAREFUL TO NOT DAMAGE YOUR CLUTCH
DURING THIS PROCESS.**

TOOLS NEEDED

- 17mm -Socket
- Torque Wrench
- 8mm Allen Wrench socket
- T30 Torx
- Blue Locktite
- Vorhees Vice holding tool or equivalent



ESTIMATED INSTALL TIME

10 MINUTES

- 1) Remove belt box cover. (T30 Torx)
- 2) Remove CVT belt. (Clutch Belt removal tool)
- 3) Remove the stock secondary clutch bolt and collar washer - these will NOT be re used. (17mm Socket)
- 4) Install the KWIK LOCK bolt and quick change washer bushing to replace the OEM bolt and washer; **USE BLUE LOCKTITE!**
 - a) **(IF YOU HAVE THE KWI Float Mod)** Use the included float spacer that has a larger hole to fit the KWIK LOCK secondary bolt. Discard your original float spacer. Shim secondary clutch to align belt in accordance with the KWI Float Mod Instructions. **USE BLE LOCKTITE!**
 - b) **(No KWI Float Mod)** Install the KWIK LOCK bolt and quick change collar washer as you would the OEM bolt and washer. **USE BLE LOCKTITE!**
- 5) Secure secondary clutch on shaft by torquing the secondary clutch bolt to bolt manufacturer specs.(8mm Allen Wrench socket)(Torque Wrench) Use a KWI Vorhees Vise holding tool or equivalent to hold secondary while torquing.
- 6) Reinstall CVT belt using your new KWIK LOCK tool.
 - a) *****If you are using a stock helix***** we have included the adapter disc so the KWIK Loc rollers ride on a smooth surface. Simply put this disc on the helix before using the KWIK Loc tool and slide it off after you have completed the belt removal/installation.
- 7) Reinstall belt box cover.

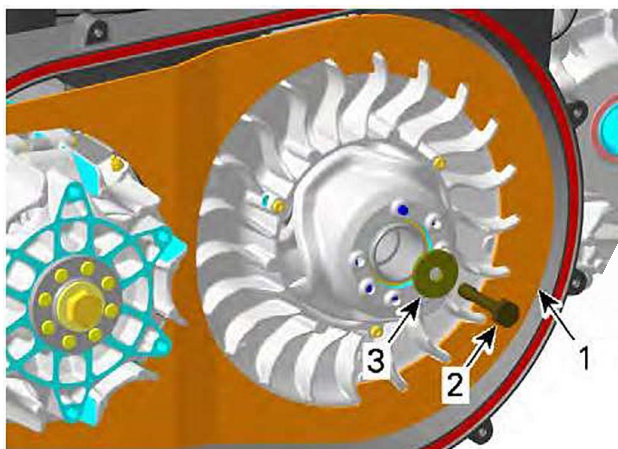

- 1 Clutch enclosure
- 2 Stock secondary bolt(remove - not reused)
- 3 Stock Collar washer (remove - not reused)



4. KWIK Loc secondary bolt
5. KWIK Loc Collar washer

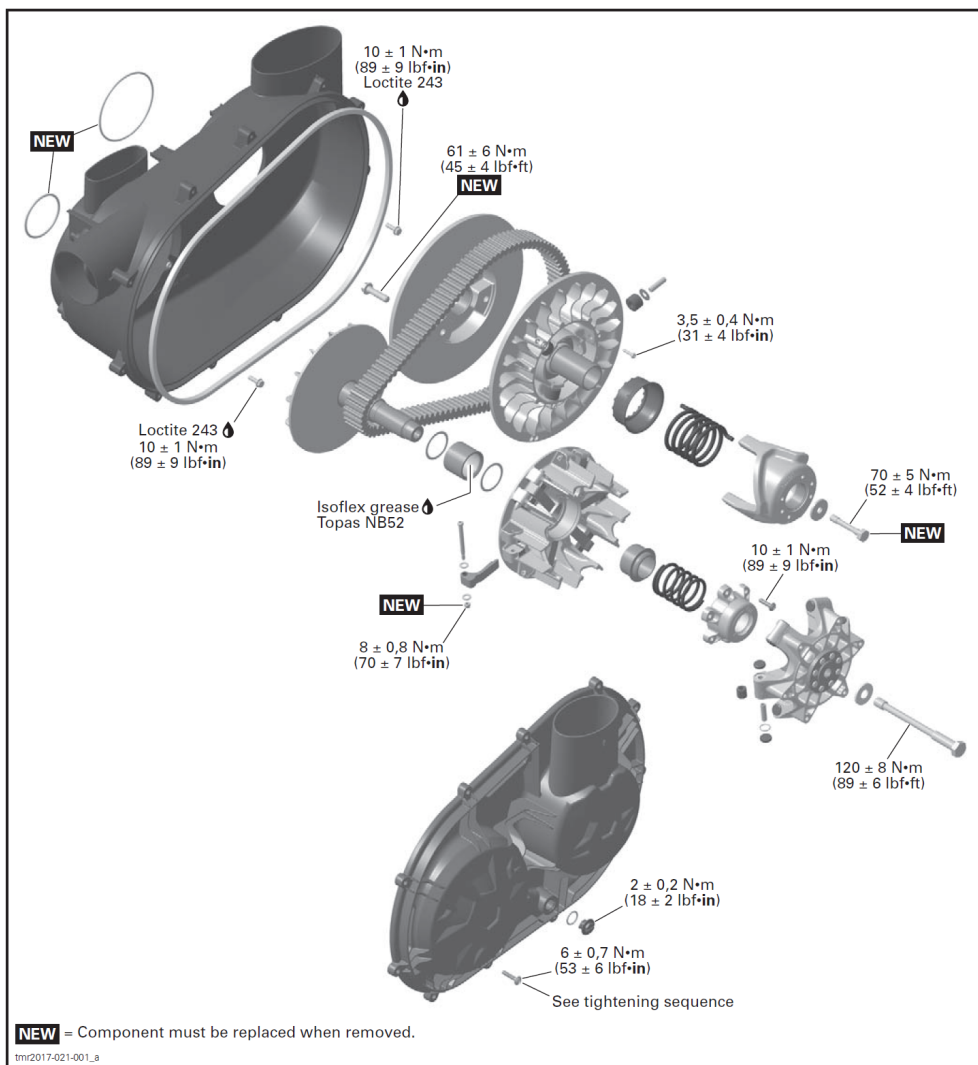

KWIKLOCKX3 PARTS INCLUDED

PART DESCRIPTION	QTY	OEM PART #	OUR PART #
KWIK LOCK BELT CHANGE TOOL	1	—	KLT
M10 X 1.5 X 100MM SCREW	1	—	M10
KWIK LOCK WASHER BUSHING	1	—	KLW
ADAPTER DISC FOR STOCK HELIX	1	—	—
		—	—
		—	—
		—	—

LIABILITY STATEMENT

As defined by the Magnuson-Moss warranty Act. Do not install any performance parts or services unless you have the technical ability to properly set-up the entire machine to compensate for the installation of those parts. The necessary work and expertise needed to install different product varies. Instructions, where provided, are given to assist in installation only; they are not a substitute for mechanical experience in setting up racing vehicles. References to performance gains, reliability, ease of installation, etc. are based on our and outside customer's experiences. This is not a guarantee of similar performance in every installation. While we sell proven products, in the end it's up to the individual to make the most of the product. Kris Werth Inc. d.b.a. KWI Clutching or its associated corporations are not responsible for any personal or property damages caused by this product. Kris Werth Inc. d.b.a. KWI Clutching or its associated corporations assumes no responsibility for damage or injury of any kind because of misuse, improper installation or improper application of any parts in anyway, by any person. Contact your local dealer to schedule installation of this kit if you are not a qualified ATV or UTV mechanic. USE OF PRODUCTS, BUYER SHALL USE, AND REQUIRE ITS EMPLOYEES, CONTRACTORS, AND AGENTS TO USE, ALL AVAILABLE SAFETY PRECAUTIONS, IN ADDITION TO ANY SPECIFICALLY SET FORTH IN ANY MANUALS, MATERIAL SAFETY DATA SHEETS, TECHNICAL DATA SHEETS, INSTRUCTION SHEETS, IF ANY, FURNISHED BY SELLER (OR AVAILABLE FROM RAW MATERIAL SUPPLIERS) RELATING TO SELLER'S PRODUCTS. IF BUYER DOES NOT RECEIVE ANY REQUIRED MATERIAL SAFETY DATA SHEETS FOR ANY PRODUCT FROM SELLER, BUYER WILL REQUEST THEM FROM SELLER. IF BUYER FAILS TO STRICTLY OBSERVE EACH AND EVERY ONE OF THE OBLIGATIONS SET FORTH IN THIS SECTION 22 OR IF BUYER'S USE OF ANY OF SELLER'S PRODUCTS IS IN VIOLATION OF ANY STANDARD OR RULE OF THE AMERICAN NATIONAL STANDARDS INSTITUTE OR OCCUPATIONAL HEALTH AND SAFETY ACT, OR OTHER APPLICABLE WORKPLACE LAW, REGULATION, OR STANDARD, BUYER WILL INDEMNIFY, DEFEND, AND HOLD HARMLESS SELLER AND SELLER AND ITS EMPLOYEES, OFFICERS, DIRECTORS, AGENTS, AFFILIATES, SUCCESSORS AND ASSIGNS FROM AND AGAINST ANY AND ALL CLAIMS, DEMANDS, DAMAGES, ACTIONS, AND CAUSES OF ACTION, AS WELL AS ANY AND ALL LIABILITY, LOSS, OR EXPENSE OF ANY KIND, INCLUDING REASONABLE ATTORNEYS' FEES ARISING FROM, CONNECTED WITH OR IN ANY WAY PERTAINING TO ANY SUCH FAILURE BY BUYER. NOTIFICATION. BUYER SHALL NOTIFY SELLER PROMPTLY, AND IN ANY EVENT WITHIN 30 DAYS, AFTER ANY ACCIDENT OR FAILURE INVOLVING SELLER'S PRODUCTS THAT RESULTS IN PERSONAL INJURY OR DAMAGE TO PROPERTY AND SHALL COOPERATE FULLY WITH SELLER IN INVESTIGATING AND DETERMINING CAUSES OF SUCH ACCIDENT OR FAILURE. ATTORNEYS' FEES AND COSTS. BUYER WILL PAY SELLER'S REASONABLE ATTORNEYS' FEES AND OTHER COSTS AND EXPENSES FOR ANY LEGAL OR EQUITABLE ACTION UNDERTAKEN BY SELLER TO ENFORCE THESE TERMS OR THE PROVISIONS OF ANY SUPPLY AGREEMENT.