

PART NUMBER(s): KWIRLR

**WE ARE NOT RESPONSIBLE FOR ANY DAMAGES.
BE VERY CAREFUL TO NOT DAMAGE YOUR CLUTCH
DURING THIS PROCESS.**

TOOLS NEEDED

- Impact
- Clutch Belt removal tool
- T30 Torx
- T20 Torx
- 13mm Socket
- 17mm Socket
- Bench Vise
- Penetrating oil
- Punch (1/4" roll pin punch recommended)
- Hammer
- Torque Wrench
- KWI "The Hammer" Roller Pin Removal Tool
Part #: HAMMER
- KWI Clutch Tool Kit or equivalent
Part #: MAVTOOL

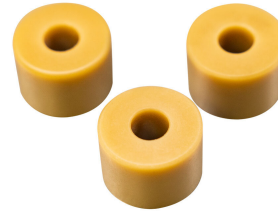

ESTIMATED INSTALL TIME

- 1 Hour

STEP

- 1) Remove belt box cover (T30 Torx).
- 2) Remove CVT belt (Clutch Belt removal tool).
- 3) Remove secondary clutch (17mm socket and impact).
- 4) Disassemble secondary clutch (KWI Secondary Clutch Tool Kit or equivalent)(13mm Socket).
- 5) Remove roller pin retaining screws (T20 Torx)
- 6) Apply a small amount of penetrating oil to roller pins at side of old rollers (Penetrating lubricant)
- 7) Remove secondary roller pins only far enough to remove the OEM roller and install new roller with OEM steel thrust washer reinstalled. (KWI "The Hammer" Roller Pin Removal Tool)
- 8) Using hammer and punch drive the pin back into the secondary, be sure to hold the thrust washer and roller in alignment with the pin while installing so you don't damage the roller. A second person holding the roller and washer in alignment helps. If the roller is not held in alignment while the pin is installed then the pin may hit the side of the roller and cause it to not roll freely- in this case you must remove the roller and de-burr the damage to the hole. (Punch- 1/4" roll pin punch recommended)(Hammer)
- 9) If the roller does not spin freely you may notice that the bottom of the secondary clutch roller pocket casting is hitting the roller- we have a video on you tube showing the fix with a grinder (Search YouTube for [Secondary Roller Removal "The Hammer"](#))
- 10) Check that your new Secondary Rollers spin freely and reinstall roller pin retaining screws being careful not to strip the threads. (T20 Torx)
- 11) Reassemble the secondary clutch. (KWI Secondary Clutch Tool Kit or equivalent)(13mm Socket).
- 12) Reinstall and torque secondary. (17mm socket)

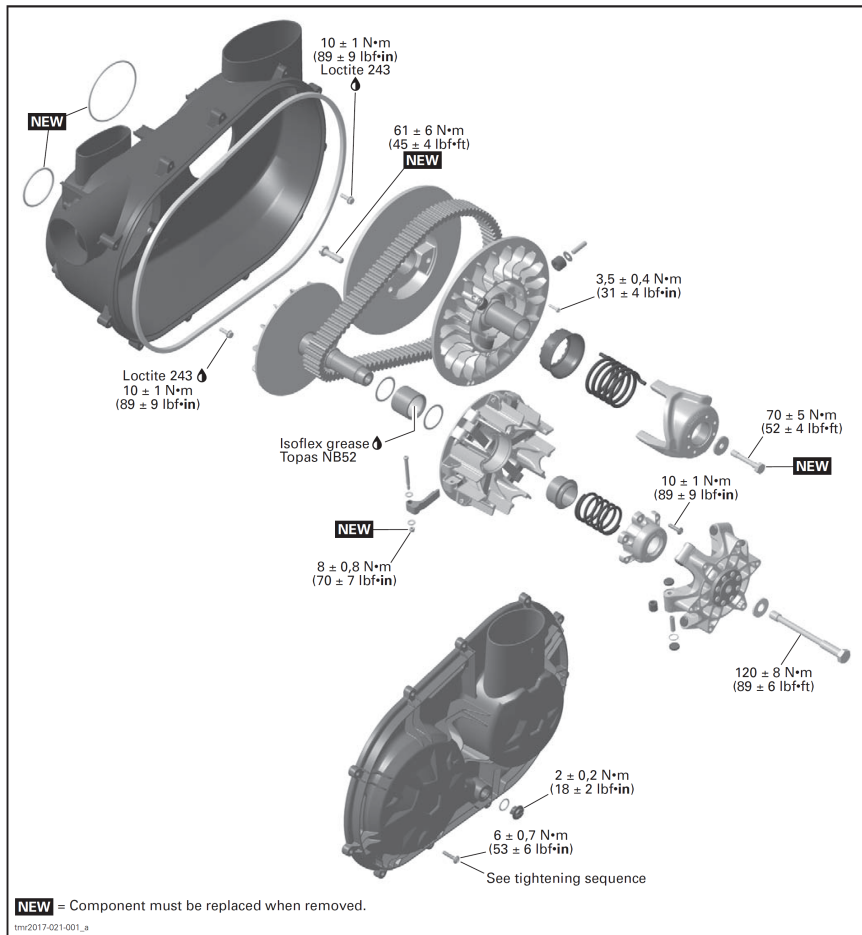

PARTS INCLUDED

PART DESCRIPTION	QTY	OEM PART #	OUR PART #
SECONDARY CLUTCH ROLLER (EACH)	3	—	KWIRLR

LIABILITY STATEMENT

As defined by the Magnuson-Moss warranty Act. Do not install any performance parts or services unless you have the technical ability to properly set-up the entire machine to compensate for the installation of those parts. The necessary work and expertise needed to install different product varies. Instructions, where provided, are given to assist in installation only; they are not a substitute for mechanical experience in setting up racing vehicles. References to performance gains, reliability, ease of installation, etc. are based on our and outside customer's experiences. This is not a guarantee of similar performance in every installation. While we sell proven products, in the end it's up to the individual to make the most of the product. Kris Werth Inc. d.b.a. KWI Clutching or its associated corporations are not responsible for any personal or property damages caused by this product. Kris Werth Inc. d.b.a. KWI Clutching or its associated corporations assumes no responsibility for damage or injury of any kind because of misuse, improper installation or improper application of any parts in anyway, by any person. Contact your local dealer to schedule installation of this kit if you are not a qualified ATV or UTV mechanic. USE OF PRODUCTS. BUYER SHALL USE, AND REQUIRE ITS EMPLOYEES, CONTRACTORS, AND AGENTS TO USE, ALL AVAILABLE SAFETY PRECAUTIONS, IN ADDITION TO ANY SPECIFICALLY SET FORTH IN ANY MANUALS, MATERIAL SAFETY DATA SHEETS, TECHNICAL DATA SHEETS, INSTRUCTION SHEETS, IF ANY, FURNISHED BY SELLER (OR AVAILABLE FROM RAW MATERIAL SUPPLIERS) RELATING TO SELLER'S PRODUCTS. IF BUYER DOES NOT RECEIVE ANY REQUIRED MATERIAL SAFETY DATA SHEETS FOR ANY PRODUCT FROM SELLER, BUYER WILL REQUEST THEM FROM SELLER. IF BUYER FAILS TO STRICTLY OBSERVE EACH AND EVERY ONE OF THE OBLIGATIONS SET FORTH IN THIS SECTION 22 OR IF BUYER'S USE OF ANY OF SELLER'S PRODUCTS IS IN VIOLATION OF ANY STANDARD OR RULE OF THE AMERICAN NATIONAL STANDARDS INSTITUTE OR OCCUPATIONAL HEALTH AND SAFETY ACT, OR OTHER APPLICABLE WORKPLACE LAW, REGULATION, OR STANDARD, BUYER WILL INDEMNIFY, DEFEND, AND HOLD HARMLESS SELLER AND SELLER AND ITS EMPLOYEES, OFFICERS, DIRECTORS, AGENTS, AFFILIATES, SUCCESSORS AND ASSIGNS FROM AND AGAINST ANY AND ALL CLAIMS, DEMANDS, DAMAGES, ACTIONS, AND CAUSES OF ACTION, AS WELL AS ANY AND ALL LIABILITY, LOSS, OR EXPENSE OF ANY KIND, INCLUDING REASONABLE ATTORNEYS' FEES ARISING FROM, CONNECTED WITH OR IN ANY WAY PERTAINING TO ANY SUCH FAILURE BY BUYER. NOTIFICATION. BUYER SHALL NOTIFY SELLER PROMPTLY, AND IN ANY EVENT WITHIN 30 DAYS, AFTER ANY ACCIDENT OR FAILURE INVOLVING SELLER'S PRODUCTS THAT RESULTS IN PERSONAL INJURY OR DAMAGE TO PROPERTY AND SHALL COOPERATE FULLY WITH SELLER IN INVESTIGATING AND DETERMINING CAUSES OF SUCH ACCIDENT OR FAILURE. ATTORNEYS' FEES AND COSTS. BUYER WILL PAY SELLER'S REASONABLE ATTORNEYS' FEES AND OTHER COSTS AND EXPENSES FOR ANY LEGAL OR EQUITABLE ACTION UNDERTAKEN BY SELLER TO ENFORCE THESE TERMS OR THE PROVISIONS OF ANY SUPPLY AGREEMENT.