

**PART NUMBER(s): MAVTOOL**

**WE ARE NOT RESPONSIBLE FOR ANY DAMAGES.  
BE VERY CAREFUL TO NOT DAMAGE YOUR CLUTCH  
DURING THIS PROCESS.**

### TOOLS NEEDED

- 1/2" Drive Impact Gun
- 22mm or 7/8" - Wrench
- 24mm or 15/16" - 1/2" Drive Impact Socket
- 14mm or 9/16" - 1/2" Drive Impact Socket
- 22mm or 7/8" - 1/2" Drive Impact Socket
- 13mm or 1/2" - 1/2" Drive Impact Socket
- 17mm - 1/2" Drive Impact Socket
- Torque Wrench
- 6mm Allen Wrench
- T30 Torx
- T40 Torx
- Clutch Belt removal tool
- Moly Grease



NOTE: No component marking is required before disassembly. This drive pulley features factory apposed index marks as references if needed.

### Removing and installing primary clutch (PDrive and QRSX)

- 1) Remove belt box cover. (T30 Torx)
- 2) Remove CVT belt. (Clutch Belt removal tool)
- 3) Remove primary clutch bolt. (22mm - 1/2" Drive Impact Socket)
- 4) Thread clutch puller into primary clutch and tighten until clutch pops off crankshaft. (14mm or 9/16" - 1/2" Drive Impact Socket)(1/2" Drive Impact Gun)
- 5) Clean crankshaft and clutch taper with acetone or brake cleaner.
- 6) Secure primary clutch on crankshaft by torquing the primary clutch bolt to bolt manufacturer specs.(22mm or 7/8" - 1/2" Drive Socket)(Torque Wrench)
- 7) Reinstall CVT belt and belt box cover.

### Removing and installing secondary clutch (PDrive and QRSX)

- 1) Remove belt box cover. (T30 Torx)
- 2) Remove CVT belt. (Clutch Belt removal tool)
- 3) Remove secondary clutch bolt. (17mm or 7/8" - 1/2" Drive Socket)
- 4) Secondary clutch will slide off shaft.
- 5) (KWI Float Mod) Reinstall secondary clutch in accordance with the KWI Fload Mod Instructions.
- 6) (No KWI Float Mod) Align splines and slide secondary clutch on shaft.
- 7) Secure secondary clutch on crankshaft by torquing the secondary clutch bolt to bolt manufacturer specs.(17mm - 1/2" Drive Socket)(Torque Wrench) Use a long 1/4" or 3/8" extension thru the helix and spring to hold secondary while torquing.
- 8) Reinstall CVT belt and belt box cover.

### **Primary clutch disassembly and reassembly (QRSX)**

- 1) Remove primary clutch. (See "Removing and installing primary clutch")
- 2) Thread clutch puller all the way in by hand and then back out 4 turns.
- 3) Put Moly grease on the top of the primary puller and on the threads of puller cup bolt.
- 4) Insert puller cup into puller plate and secure to governor cup using 6 each M8 bolts.(6mm Allen Wrench)
- 5) Tighten puller cup bolt until governor cup pops off. (STOP TIGHTENING AS SOON AS IT POPS)(1/2" Drive Impact Gun)(24mm or 15/16" - 1/2" Drive Impact Socket)
- 6) Remove puller cup, puller plate and clutch puller then disassemble clutch as required.
- 7) Clamp welded nut end of threaded rod in a suitable vise. Use threaded rod, puller cup (without bolt installed) and compression washers to compress and hold down bearing cover spring pressure for bearing cover removal and installation.

### **Primary clutch disassembly and reassembly (PDrive)**

- 1) Remove primary clutch. (See "Removing and installing primary clutch")
- 2) Thread clutch puller all the way in by hand and then back out 4 turns.
- 3) Remove 6 each Torx screws holding governor cup cap to governor cup.(T40 Torx)
- 4) Put Moly grease on the top of the primary puller and on the threads of puller cup bolt.
- 5) Insert puller cup into puller plate and secure to governor cup cap using 6 each M8 bolts.(6mm Allen Wrench)
- 6) Tighten puller cup bolt until governor cup plate pops off its taper. (STOP TIGHTENING AS SOON AS IT POPS)(1/2" Drive Impact Gun)(24mm or 15/16" - 1/2" Drive Impact Socket)
- 7) Remove puller cup, puller plate clutch puller and governor cup plate.
- 8) Place circlip remover/installer on top of spring retainer, install threaded rod through circlip installer/remover and screw into clutch approx 10 turns. Turn nut in to compress spring and take tension off of circlip. Remove circlip. Turn nut out to relax spring tension. Remove threaded rod, circlip installer/remover and disassemble clutch as required. (22mm or 7/8" - Wrench)
- 9) Reassemble in reverse order. Use threaded rod and tool disc to hold primary while torquing. All tapers will lock upon clutch installation to crankshaft.

### **Secondary clutch disassembly and reassembly (QRSX and PDrive)**

- 1) Remove secondary clutch. (See "Removing and installing secondary clutch")
- 2) Clamp welded nut end of threaded rod in a suitable vise. Place puller cup (without puller cup bolt) over threaded rod.
- 3) Place secondary clutch over threaded rod with helix Turn nut in to compress helix slightly and take tension off of helix bolts. Remove 3 helix bolts. While holding sheaves from turning (by hand) and helix from turning (with a long 1/4 or 3/8 extension inserted thru helix and spring) turn nut out to relax spring tension. Disassemble clutch as required. (22mm or 7/8" - Wrench)
- 4) Reassemble in reverse order.

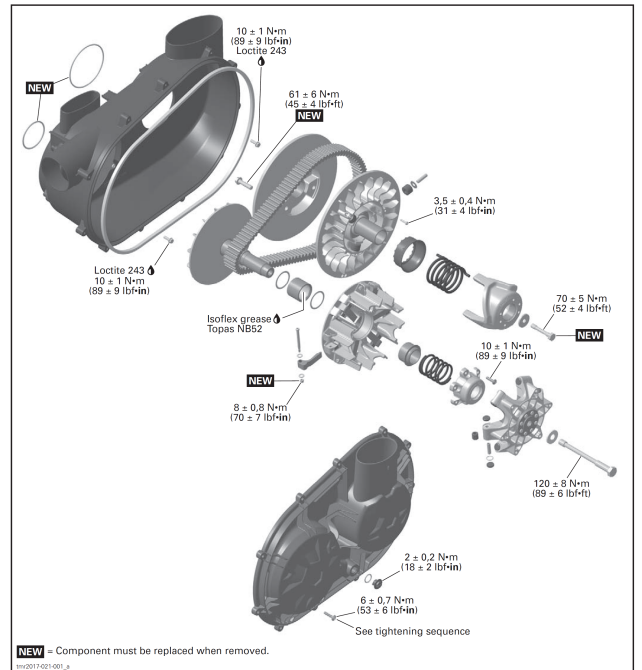
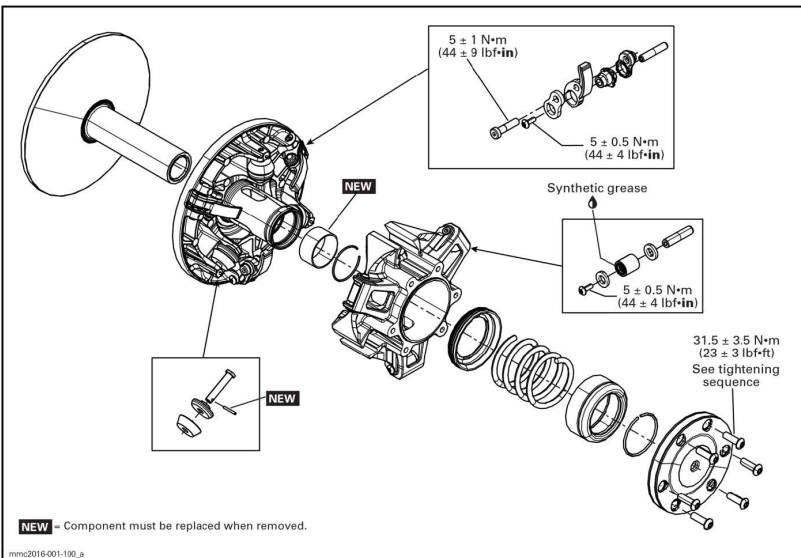
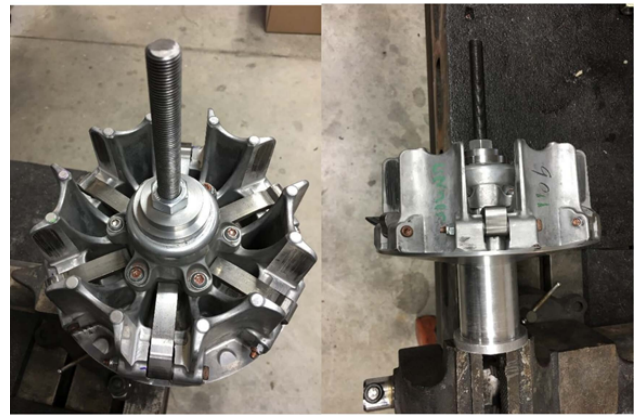
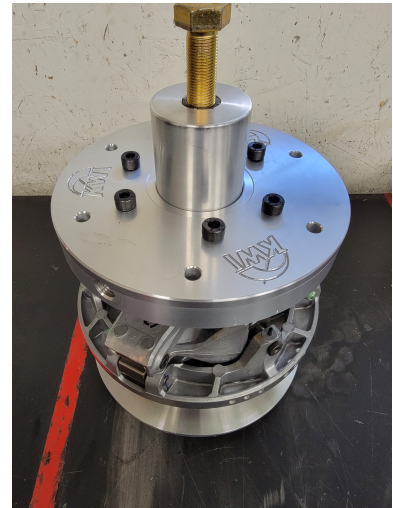



### PARTS INCLUDED

REF	PART DESCRIPTION	QTY	OEM PART #	OUR PART #
1	PRIMARY CLUTCH PULLER	1	—	—
2	PULLER CUP WITH BOLT	1	—	—
3	"THE TIP" M5 ADAPTER FOR "HAMMER"	1	—	THE TIP
4	M8 BOLTS	6	—	—
5	KWI CLUTCH TOOL PLATE	1	—	—
6	M14 X 1.5 COMPRESSION ROD AND NUTS	1	—	—
7	COMPRESSION WASHERS	1	—	—
8	CIRCLIP INSTALLER/REMOVER	1	—	—
9	CLUTCH COMPRESSION TOOL	1	—	—
10	KWI "HAMMER" PIN REMOVAL TOOL	1	—	HAMMER

#### LIABILITY STATEMENT

As defined by the Magnuson-Moss warranty Act. Do not install any performance parts or services unless you have the technical ability to properly set-up the entire machine to compensate for the installation of those parts. The necessary work and expertise needed to install different product varies. Instructions, where provided, are given to assist in installation only; they are not a substitute for mechanical experience in setting up racing vehicles. References to performance gains, reliability, ease of installation, etc. are based on our and outside customer's experiences. This is not a guarantee of similar performance in every installation. While we sell proven products, in the end it's up to the individual to make the most of the product. Kris Werth Inc. d.b.a. KWI Clutching or its associated corporations are not responsible for any personal or property damages caused by this product. Kris Werth Inc. d.b.a. KWI Clutching or its associated corporations assumes no responsibility for damage or injury of any kind because of misuse, improper installation or improper application of any parts in anyway, by any person. Contact your local dealer to schedule installation of this kit if you are not a qualified ATV or UTV mechanic. USE OF PRODUCTS. BUYER SHALL USE, AND REQUIRE ITS EMPLOYEES, CONTRACTORS, AND AGENTS TO USE, ALL AVAILABLE SAFETY PRECAUTIONS, IN ADDITION TO ANY SPECIFICALLY SET FORTH IN ANY MANUALS, MATERIAL SAFETY DATA SHEETS, TECHNICAL DATA SHEETS, INSTRUCTION SHEETS, IF ANY, FURNISHED BY SELLER (OR AVAILABLE FROM RAW MATERIAL SUPPLIERS) RELATING TO SELLER'S PRODUCTS. IF BUYER DOES NOT RECEIVE ANY REQUIRED MATERIAL SAFETY DATA SHEETS FOR ANY PRODUCT FROM SELLER, BUYER WILL REQUEST THEM FROM SELLER. IF BUYER FAILS TO STRICTLY OBSERVE EACH AND EVERY ONE OF THE OBLIGATIONS SET FORTH IN THIS SECTION 22 OR IF BUYER'S USE OF ANY OF SELLER'S PRODUCTS IS IN VIOLATION OF ANY STANDARD OR RULE OF THE AMERICAN NATIONAL STANDARDS INSTITUTE OR OCCUPATIONAL HEALTH AND SAFETY ACT, OR OTHER APPLICABLE WORKPLACE LAW, REGULATION, OR STANDARD, BUYER WILL INDEMNIFY, DEFEND, AND HOLD HARMLESS SELLER AND SELLER AND ITS EMPLOYEES, OFFICERS, DIRECTORS, AGENTS, AFFILIATES, SUCCESSORS AND ASSIGNS FROM AND AGAINST ANY AND ALL CLAIMS, DEMANDS, DAMAGES, ACTIONS, AND CAUSES OF ACTION, AS WELL AS ANY AND ALL LIABILITY, LOSS, OR EXPENSE OF ANY KIND, INCLUDING REASONABLE ATTORNEYS' FEES ARISING FROM, CONNECTED WITH OR IN ANY WAY PERTAINING TO ANY SUCH FAILURE BY BUYER.

NOTIFICATION. BUYER SHALL NOTIFY SELLER PROMPTLY, AND IN ANY EVENT WITHIN 30 DAYS, AFTER ANY ACCIDENT OR FAILURE INVOLVING SELLER'S PRODUCTS THAT RESULTS IN PERSONAL INJURY OR DAMAGE TO PROPERTY AND SHALL COOPERATE FULLY WITH SELLER IN INVESTIGATING AND DETERMINING CAUSES OF SUCH ACCIDENT OR FAILURE. ATTORNEYS' FEES AND COSTS. BUYER WILL PAY SELLER'S REASONABLE ATTORNEYS' FEES AND OTHER COSTS AND EXPENSES FOR ANY LEGAL OR EQUITABLE ACTION UNDERTAKEN BY SELLER TO ENFORCE THESE TERMS OR THE PROVISIONS OF ANY SUPPLY AGREEMENT.